

# SECTION 3

# LOCKER SYSTEMS

Overview	50
Lockers – Plinth Mounted	51
Lockers – Wall Mounted	52
Lockers – Bench Mounted	53
Lockers – Shoe Box Mounted	54
Lockers – Shoe Box Seating Mounted	55
Lockers – Plinth Mounted End-of-Trip	56
Lockers – Wall Mounted End-of-Trip	58
Lockers – Shoe Box Mounted End-of-Trip	60





**DuraCube lockers are constructed from DuraSafe 13mm compact laminate, making them suitable for wet and dry locations.**

Compact laminate is vandal, impact, and water-resistant with a low maintenance surface.

Coordinate your locker colours with partitioning systems, bench seating and vanities.

#### APPLICATIONS

- Schools and universities
- End-of-trip facilities
- Sport and gym change rooms
- Defence ablution blocks

**“The DuraCube locker range has expanded to accommodate evolving trends, making it fast and easy to design and construct with bathroom joinery systems.”**

Nick Serafin  
Marketing Manager, DuraCube

#### FEATURES & BENEFITS

- DuraSafe 13mm compact laminate construction requires no edge strip due to black core edge
- Locker carcass constructed from either:
  - water-resistant white 16mm HMR board or
  - 100% waterproof white 16mm PVC board
- Black PVC edge tape on carcass to match black core on compact laminate panels and doors
- Four door colours can be used to create a pattern
- Shelving and vent options are available
- Coat rail is a standard inclusion
- One to four doors are optional per locker tower

#### LOCK OPTIONS

- Electronic Touch Pad Lock (ETP)
- Mechanical Combination Lock (KL20)
- Padlock Hasp (PH)
- Standard Key Lock (KL)
- Electronic Button Lock (KL1000)

View lock options at:  
[duracube.com.au/bathroom-joinery-hardware-accessories](http://duracube.com.au/bathroom-joinery-hardware-accessories)

### Lockers – Plinth Mounted



#### HOW TO SPECIFY

**Product**  
DuraCube locker systems – plinth mounted (LPM)

**Door and Panel Construction Material**  
DuraSafe 13mm compact laminate

**Internal Carcass Construction Material**  
Select either:  
Dry area lockers – white or black 16mm HMR board  
Wet area lockers – white 16mm PVC board

**Lock**  
Insert lock option here – see page 50

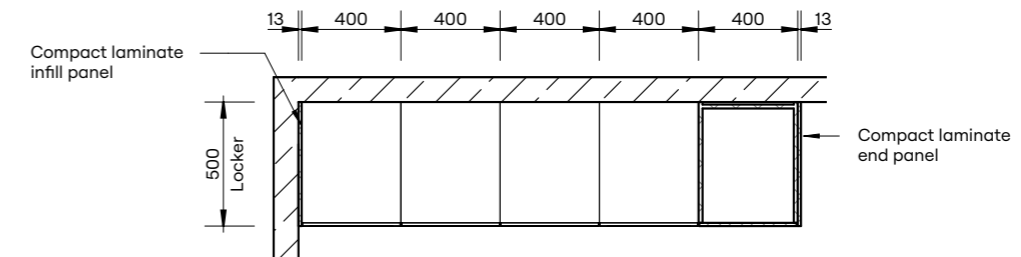

Plan

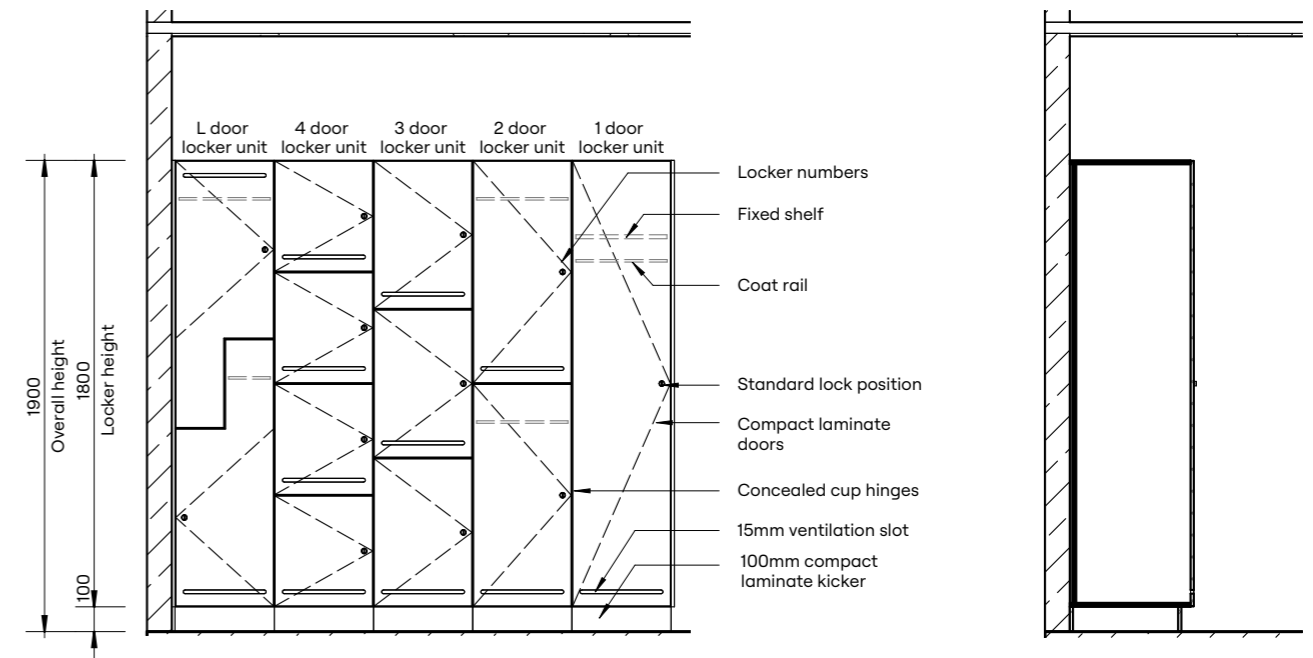

Elevation

Section



### Lockers – Wall Mounted



**HOW TO SPECIFY**

**Product**  
DuraCube locker systems – wall mounted (LWM)

**Door and Panel Construction Material**  
DuraSafe 13mm compact laminate

**Internal Carcass Construction Material**  
Select either:  
Dry area lockers – white or black 16mm HMR board  
Wet area lockers – white 16mm PVC board

**Lock**  
Select lock option here – see page 50

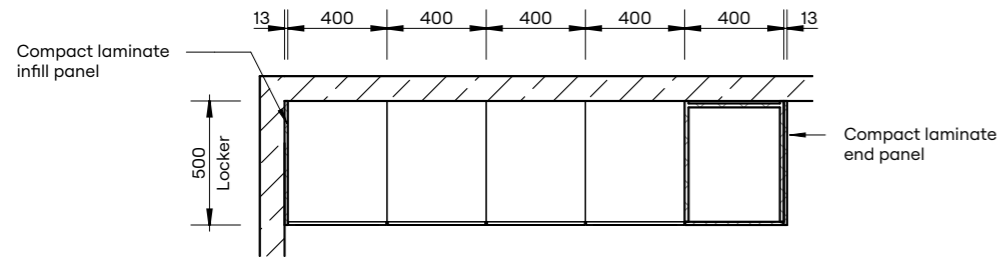

Plan

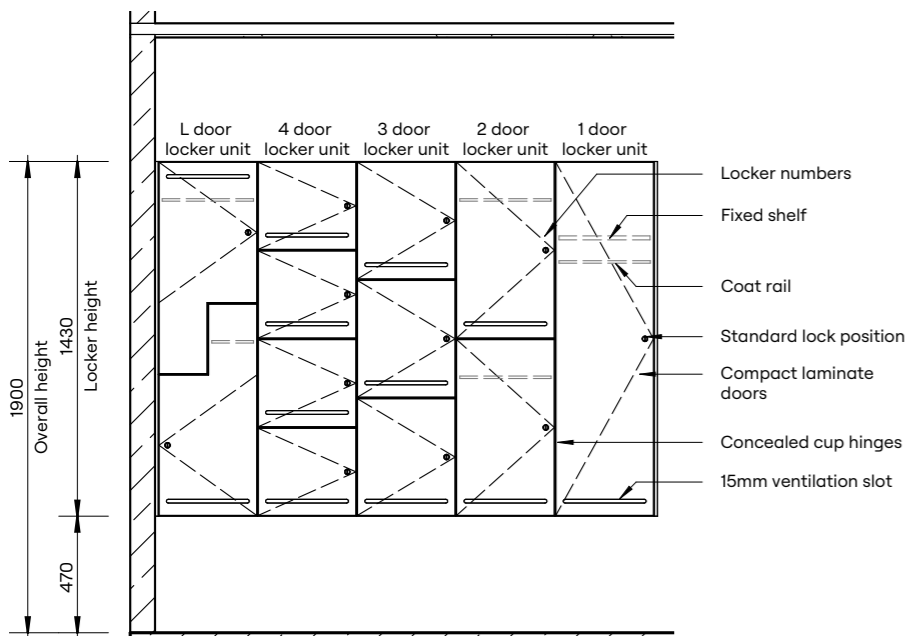

Elevation

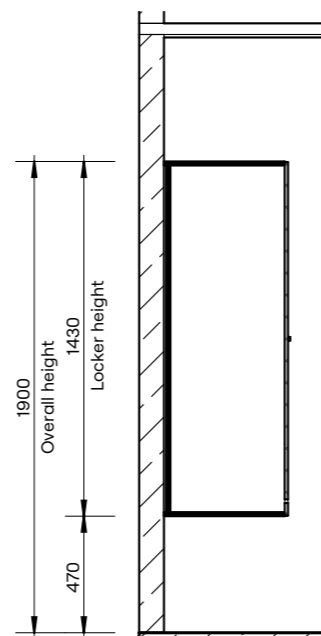

Section

### Lockers – Bench Mounted



**HOW TO SPECIFY**

**Product**  
DuraCube locker systems – bench mounted (LBM)

**Door and Panel Construction Material**  
DuraSafe 13mm compact laminate

**Internal Carcass Construction Material**  
Select either:  
Dry area lockers – white or black 16mm HMR board  
Wet area lockers – white 16mm PVC board

**Lock**  
Select lock option here – see page 50

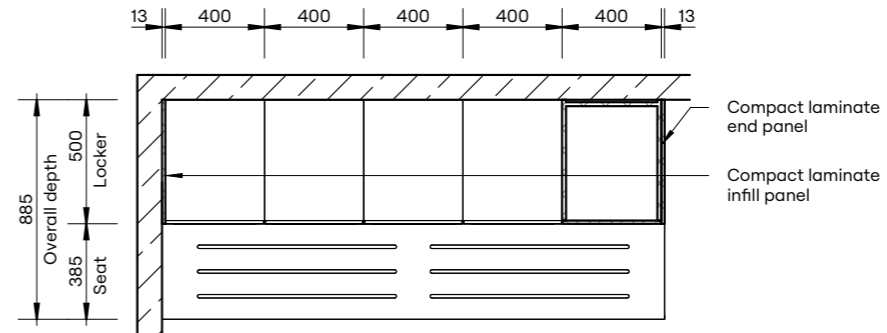

Plan

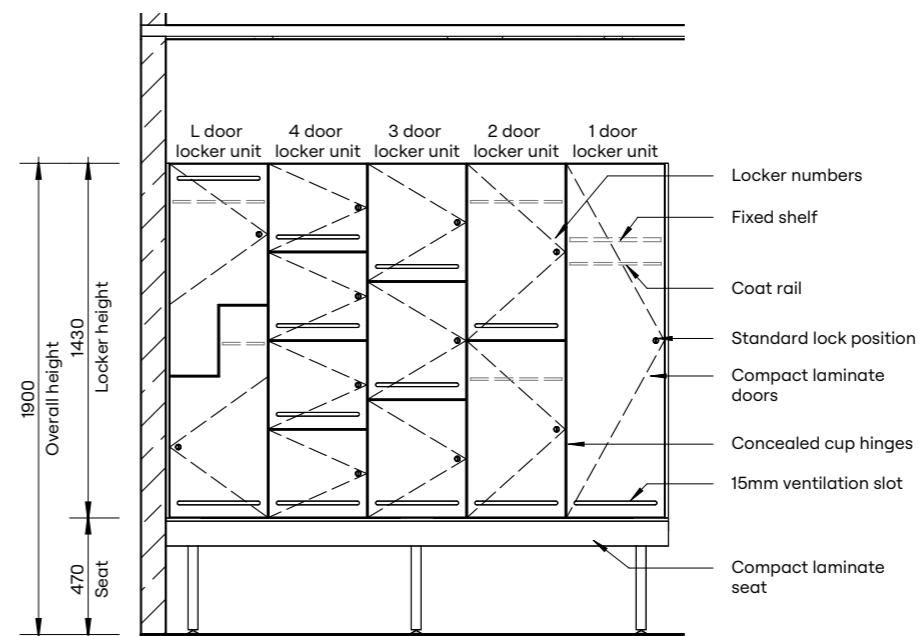

Elevation

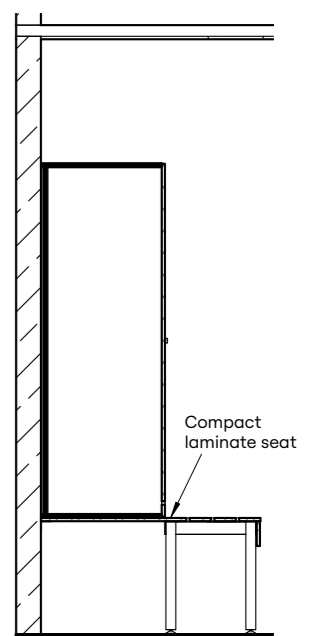

Section



### Lockers – Shoe Box Mounted



**HOW TO SPECIFY**

**Product**  
DuraCube locker systems – shoe box mounted (LSBM)

**Door and Panel Construction Material**  
DuraSafe 13mm compact laminate

**Internal Carcass Construction Material**  
Select either:  
Dry area lockers – white or black 16mm HMR board  
Wet area lockers – white 16mm PVC board

**Lock**  
Select lock option here – see page 50

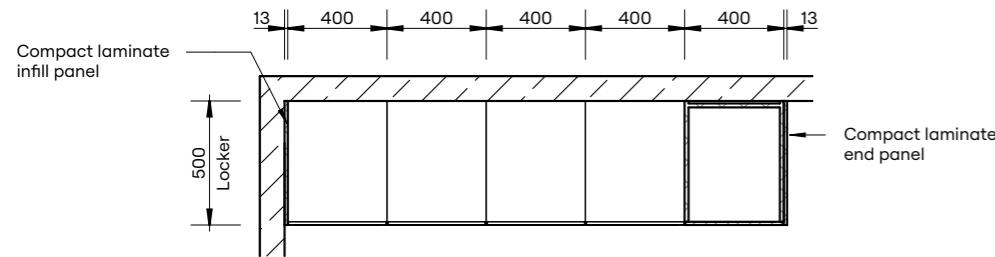

Plan

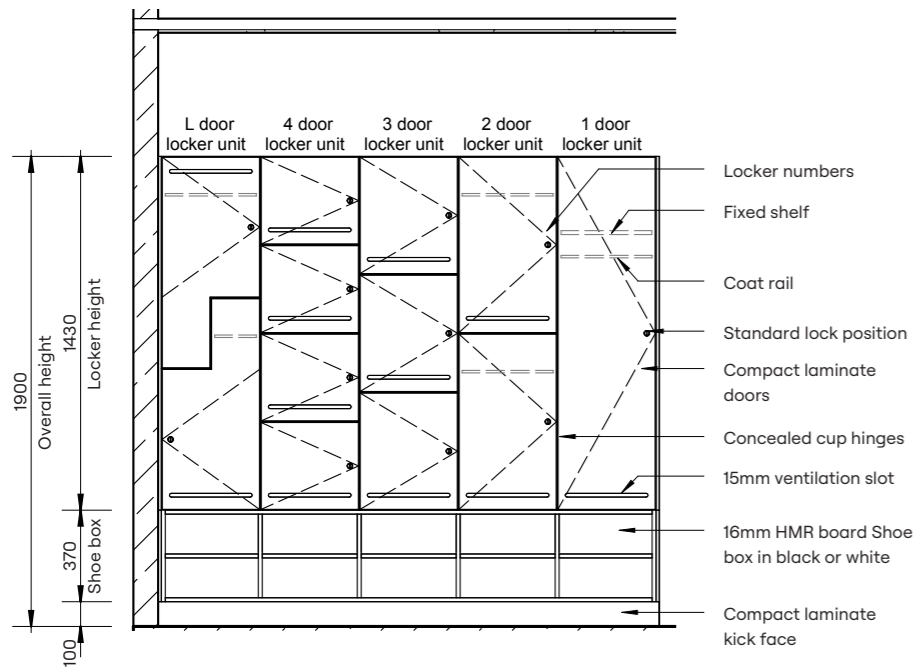

Elevation

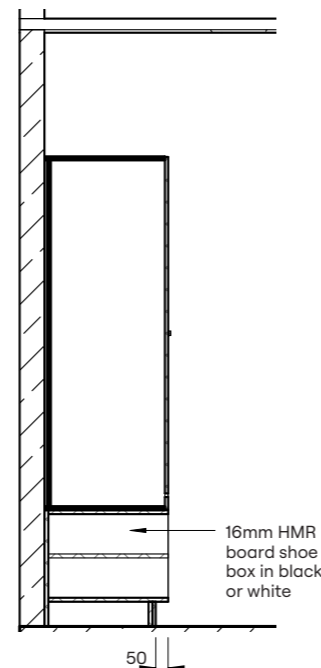

Section

### Lockers – Shoe Box Seating Mounted



**HOW TO SPECIFY**

**Product**  
DuraCube locker systems – shoe box seating mounted (LSBSM)

**Door and Panel Construction Material**  
DuraSafe 13mm compact laminate

**Internal Carcass Construction Material**  
Select either:  
Dry area lockers – white or black 16mm HMR board  
Wet area lockers – white 16mm PVC board

**Lock**  
Select lock option here – see page 50

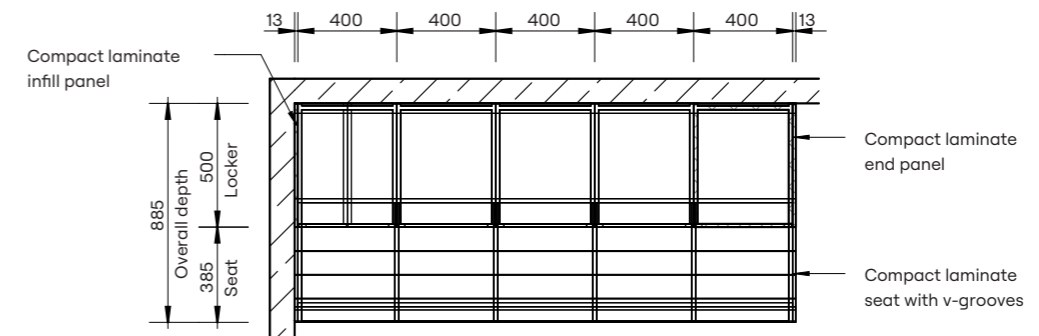

Plan

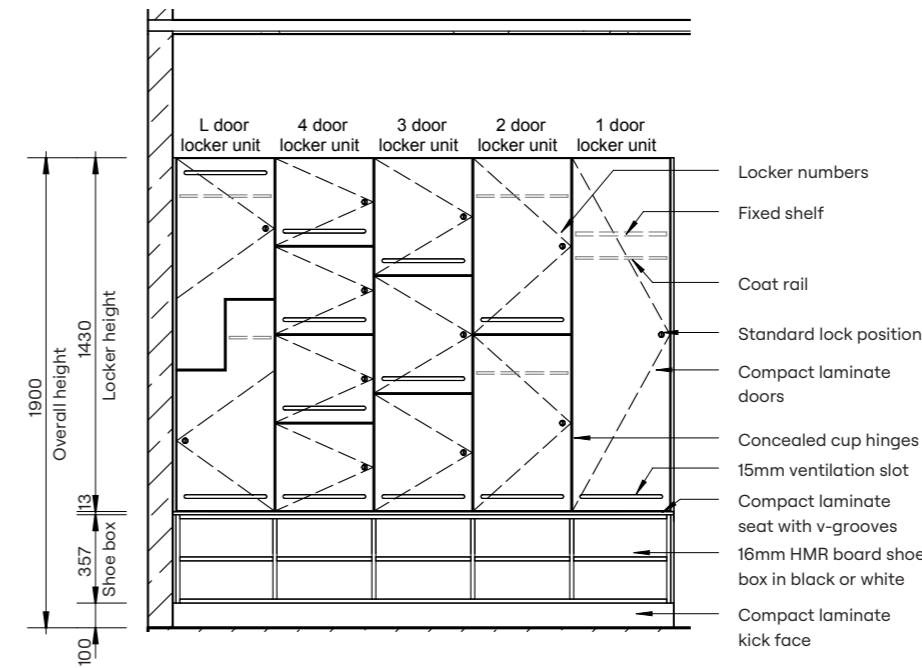

Elevation

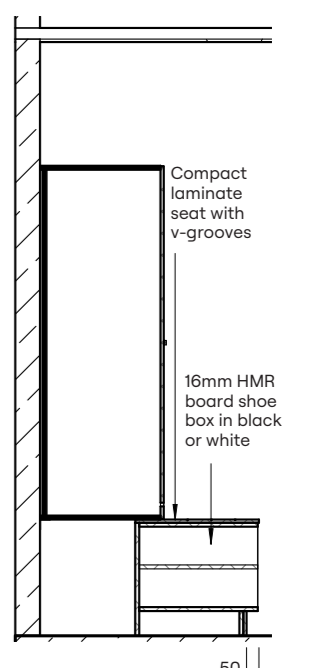

Section



Lockers – Plinth Mounted End-of-Trip



HOW TO SPECIFY	
<b>Product</b>	DuraCube locker systems – plinth mounted end-of-trip (LPM-EOT)
<b>Door and Panel Construction Material</b>	DuraSafe 13mm compact laminate
<b>Internal Carcass Construction Material</b>	Select either: Dry area lockers – white or black 16mm HMR board Wet area lockers – white 16mm PVC board
<b>Lock</b>	Select lock option here – see page 50

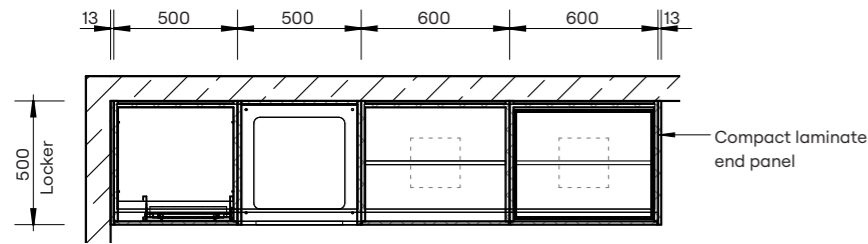

Plan

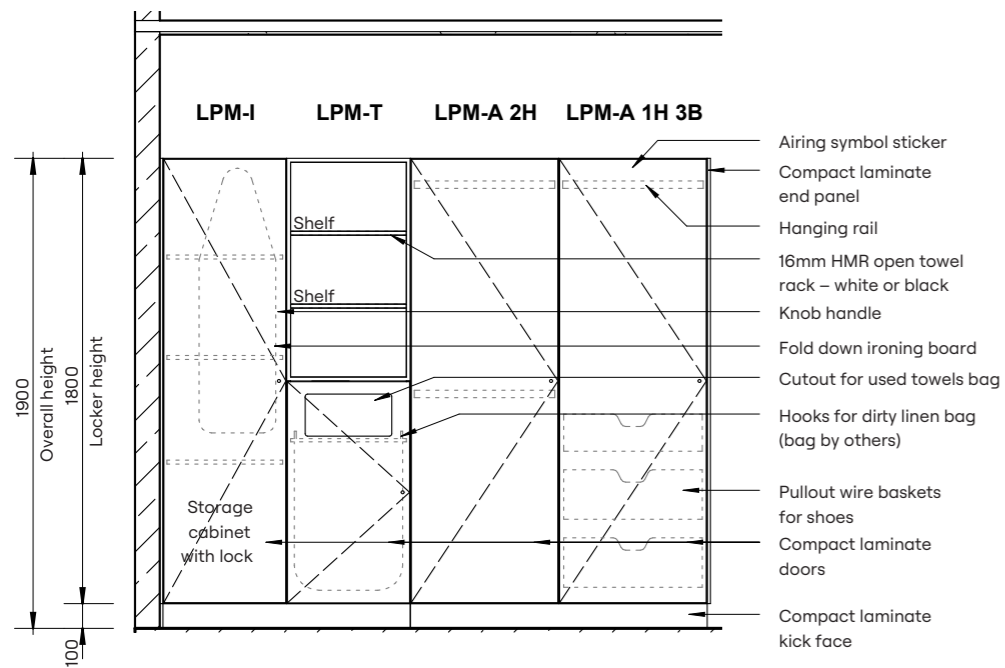

Elevation

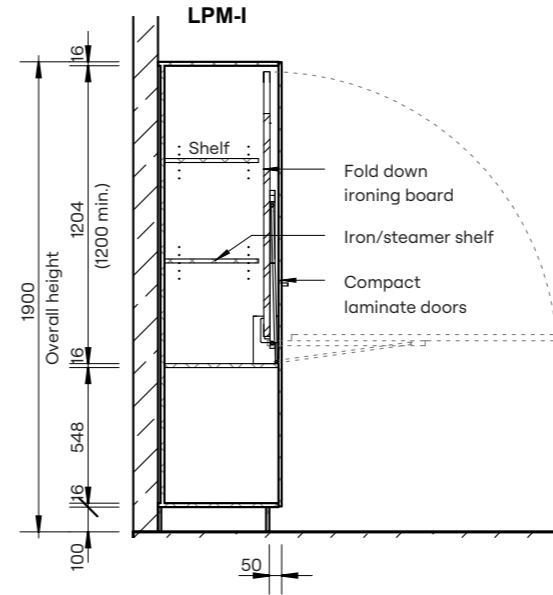

Section

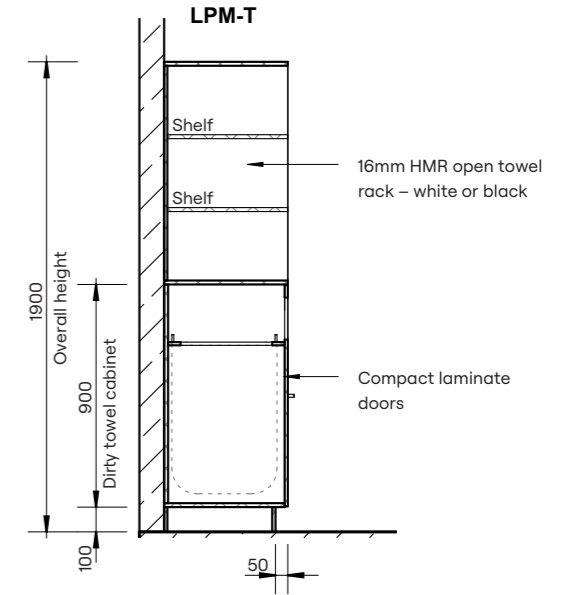

Section

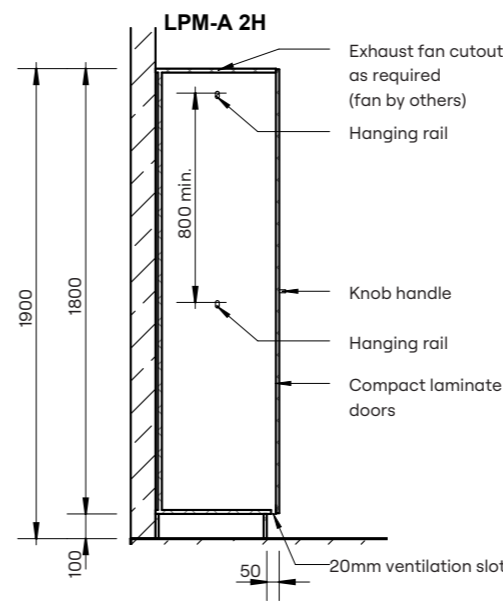

Section

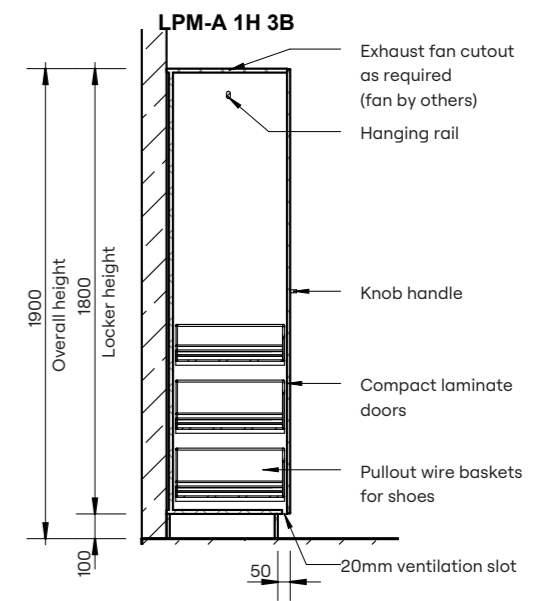

Section



### Lockers – Wall Mounted End-of-Trip



HOW TO SPECIFY	
<b>Product</b>	DuraCube locker systems – wall mounted end-of-trip (LWM-EOT)
<b>Door and Panel Construction Material</b>	DuraSafe 13mm compact laminate
<b>Internal Carcass Construction Material</b>	Select either: Dry area lockers – white or black 16mm HMR board Wet area lockers – white 16mm PVC board
<b>Lock</b>	Select lock option here – see page 50

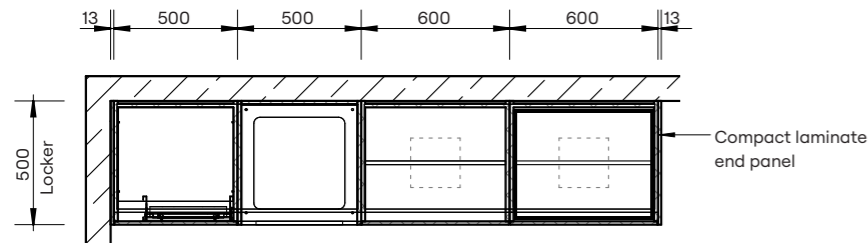

Plan

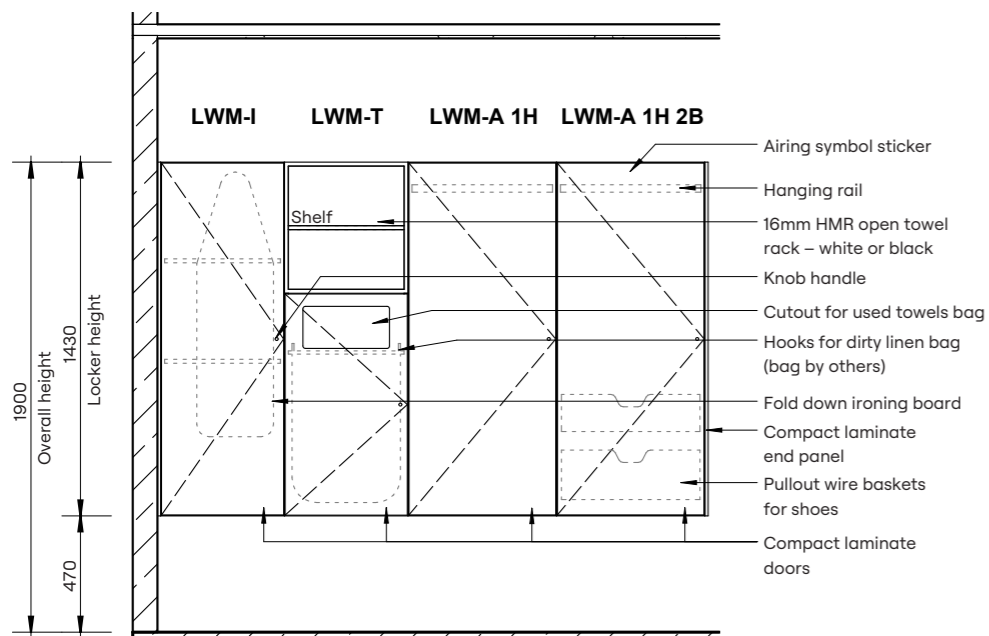

Elevation

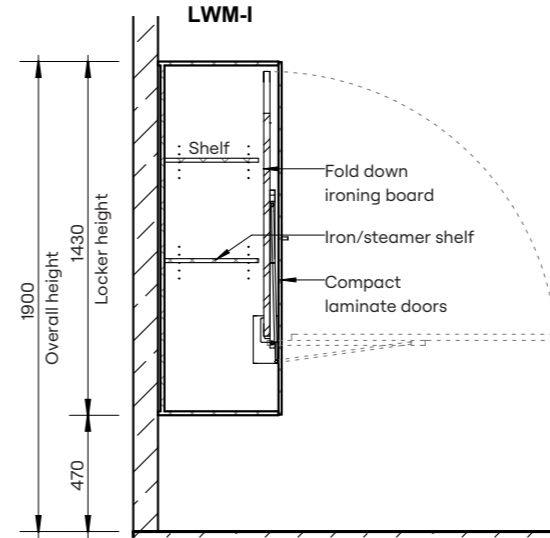

Section

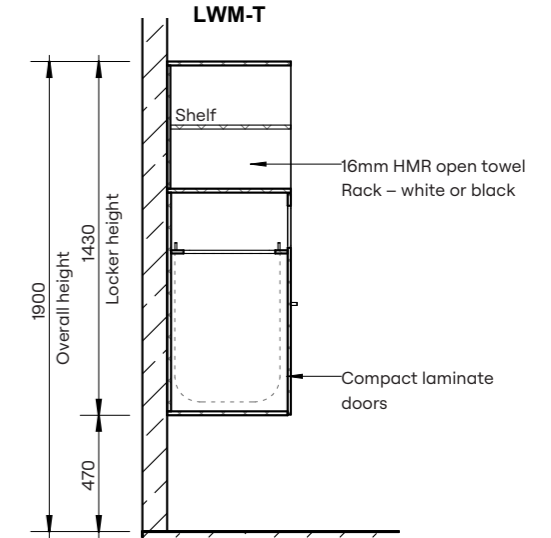

Section

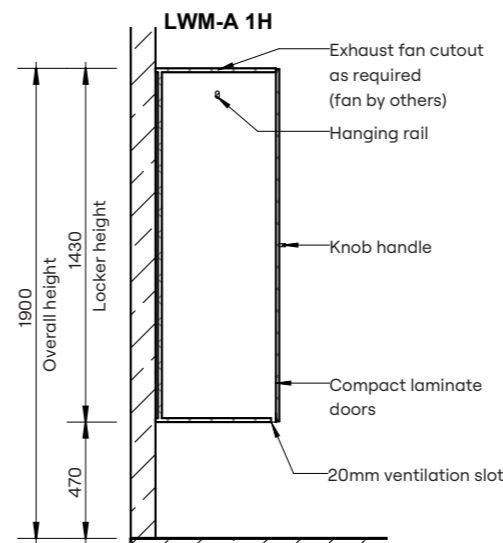

Section

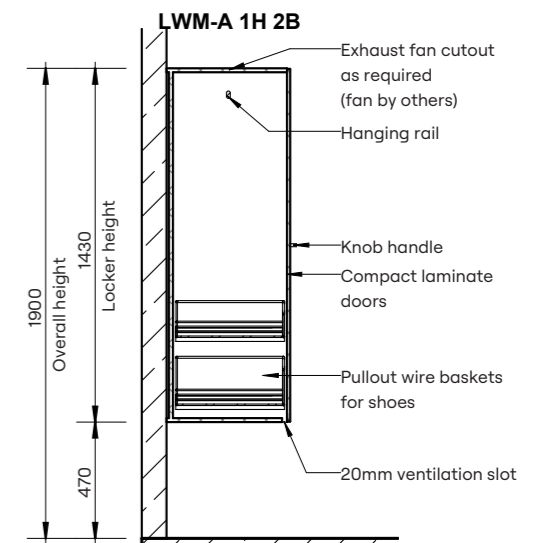

Section



Lockers – Shoe Box Mounted End-of-Trip



HOW TO SPECIFY	
<b>Product</b>	DuraCube locker systems – shoe box mounted end-of-trip (LSBM-EOT)
<b>Door and Panel Construction Material</b>	DuraSafe 13mm compact laminate
<b>Internal Carcass Construction Material</b>	Select either: Dry area lockers – white or black 16mm HMR board Wet area lockers – white 16mm PVC board
<b>Lock</b>	Select lock option here – see page 50

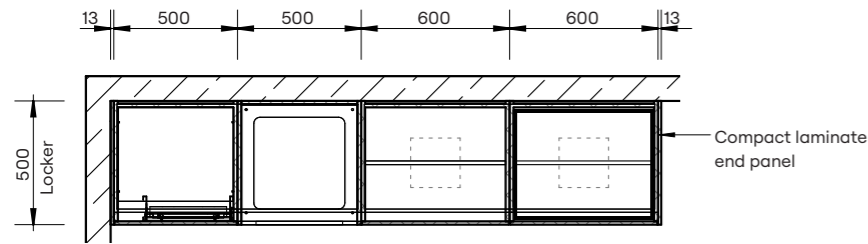

Plan

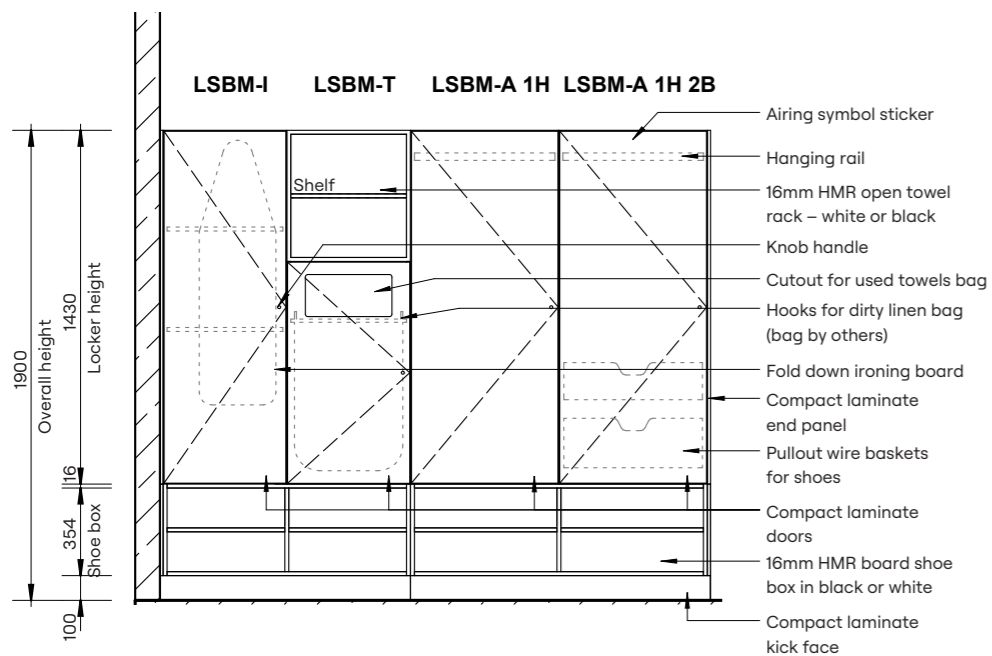

Elevation

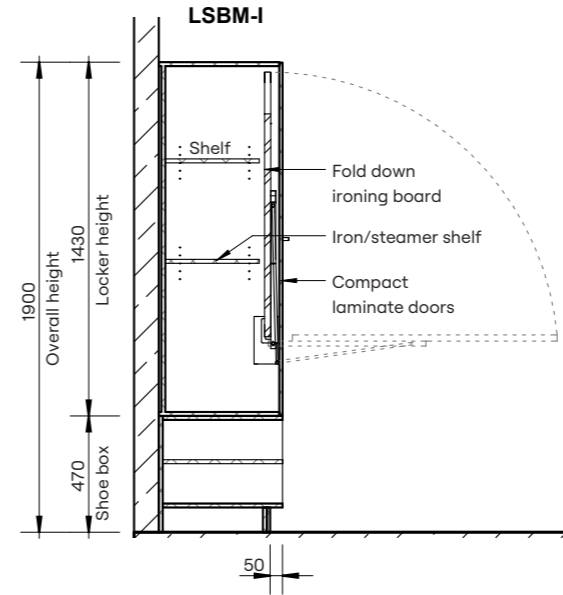

Section

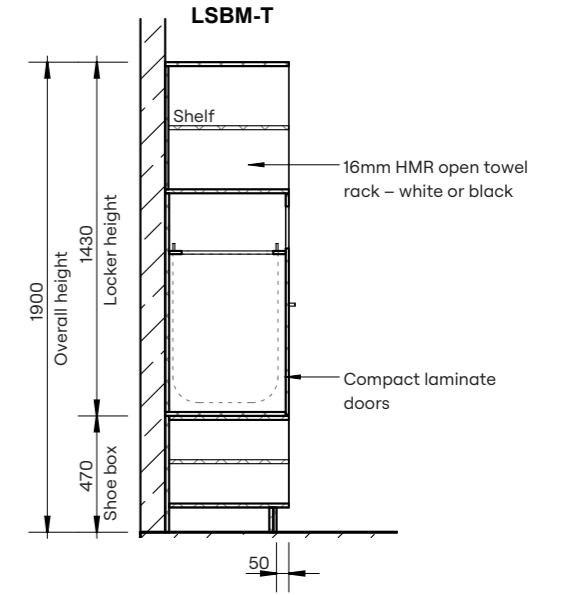

Section

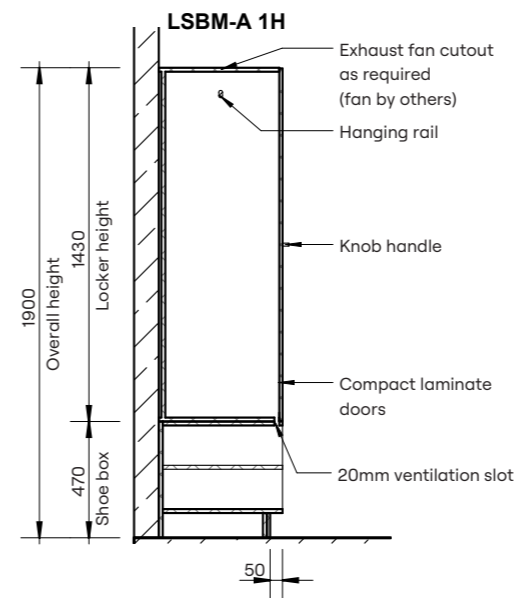

Section

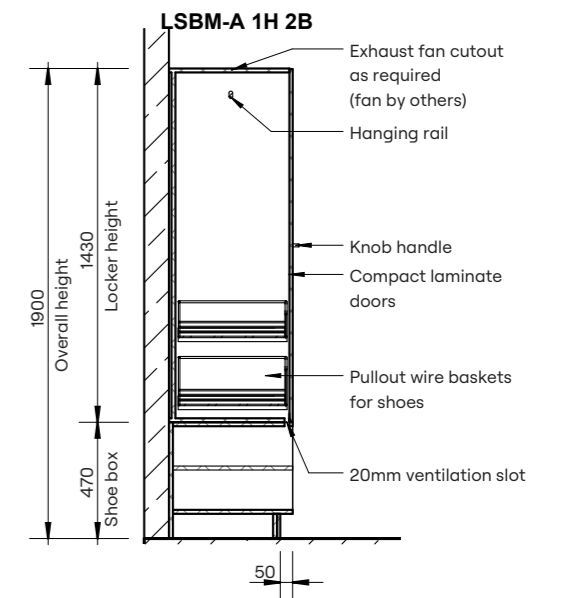

Section