



Lockers – Accessible Ironing Station (AIS)



| HOW TO SPECIFY                                |   |
|---|---|
| <b>Product</b>                                | DuraCube locker systems - plinth mounted accessible ironing station (AIS)     |
| <b>Door and Panel Construction Material</b>   | DuraSafe 13mm compact laminate  |
| <b>Internal Carcass Construction Material</b> | Select either:<br>Dry area lockers – white or black HMR<br>16mm particleboard |
| <b>Hardware</b>                               | User controlled electronic height adjustment mechanism with 100kg load rating |

Effortless single-handed adjustment for instant transitions between standing and wheelchair-accessible heights.

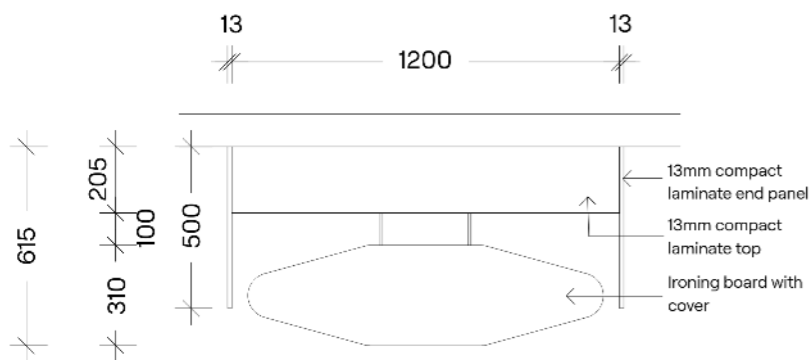

Plan

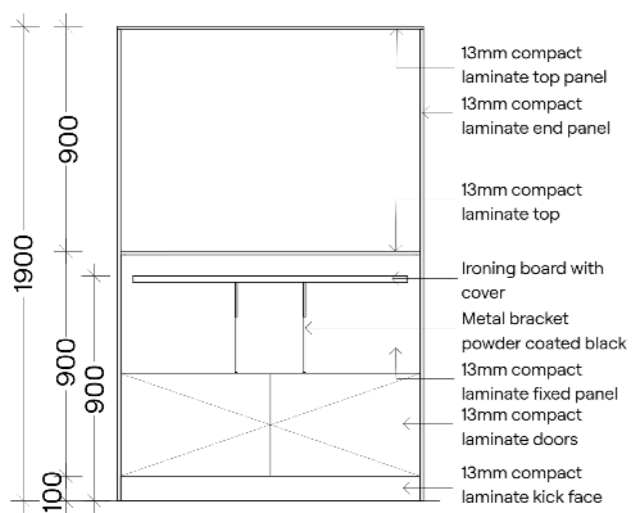

Elevation

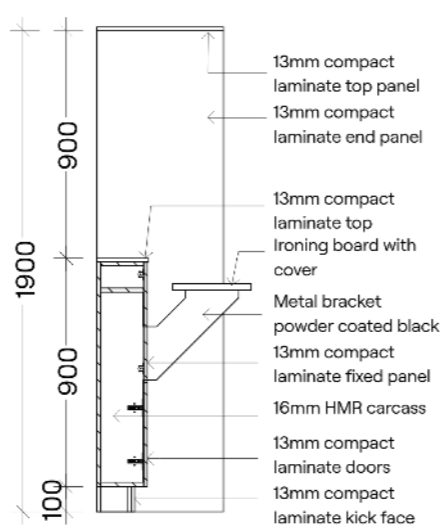

Section



DuraSafe 5394 Washed Acacia